

Mod. 2947



● **Sampling valve smooth pipe**
 Stainless steel material AISI 304. Seat PTFE material. Thread end 1/2" ISO 228/1. Max. working pressure 10 bar.

MED	R	A	L
1/2"	1/2" G	72	72

CODE	SIZE	WEIGHT kg
2947 04	1/2"	0.25

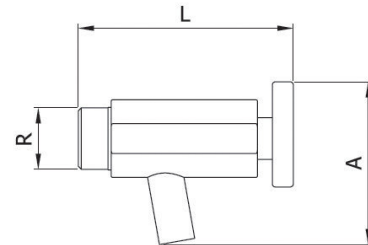

Mod. 2950



● **Sampling valve with lower valve**
 Stainless steel material AISI 304. Seat PTFE material. Thread end 1/2" ISO 228/1. Max. working pressure 10 bar.

MED	R	A	L
1/2"	1/2" G	72	72

CODE	SIZE	WEIGHT kg
2950 04	1/2"	0.3

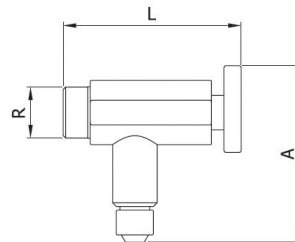

Mod. 2951



● **Clamp end sampling valve**
 Body: stainless steel 316L. Silicone sealing. Clamp ends in inches. Sanitary polish. Max. working pressure: 10 bar.

MED	A	B	C	D	E
1" - 1 1/2"	91.5	70	50.5	29	12

CODE	SIZE	WEIGHT kg
2951 06	1" - 1 1/2"	0.55

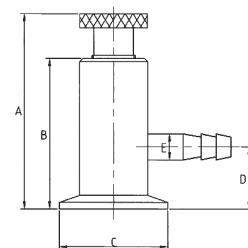

Mod. 2952

● **Cleaning ball**

Body: stainless steel 316L. Threaded ends
BSP DIN 2999. Cleaning angle 360°.
Sanitary polish. Double bearing (2).



CODE	SIZE	WEIGHT kg
2952 06	1"	0.4
2952 08	1 1/2"	0.75
2952 09	2"	1.1

MED	DN	A	B	C	D
1"	25	146	52	1" BSP	22
1 1/2"	40	173	63	1 1/2" BSP	27
2"	50	202	75	2" BSP	34

