

## MANUAL ANGLE SEAT VALVE, G 1/2" ÷ 2"; BRONZE

flow over / under seat

TYPE: CG MANUAL

### TECHNICAL SPECIFICATIONS

Media: water, oil, air, aggressive media and steam<sup>(1)</sup>

Media temperature: -10°C ... +180°C

Ambient temperature: -10°C ... +60°C

Body material: (CC491K EN 1982: 2000)

Bonnet material: (CW617N EN 12165: 1999)

Seal material: PTFE

### OPTIONS

NPT connection (ex. code CN2050TW00)



SELECTION TABLE	VALVES	connection	DN orifice	Flow rate Kvs	Working pressure <sup>(1)</sup>		Flow direction
	Code	(ISO 228 G)	(mm)	(l/min)	min (bar)	max (bar)	
	CG2050TW00	1/2"	15	87	0	25	1 ↔ 2
	CG2060TX00	3/4"	20	164	0	25	1 ↔ 2
	CG2070TY00	1"	25	260	0	25	1 ↔ 2
	CG2080TZ00	1 1/4"	32	410	0	25	1 ↔ 2
	CG2090TK00	1 1/2"	40	700	0	25	1 ↔ 2
	CG2100TJ00	2"	50	916	0	16	1 ↔ 2

(1) Steam: Max. working pressure 10 bar (9 barg);

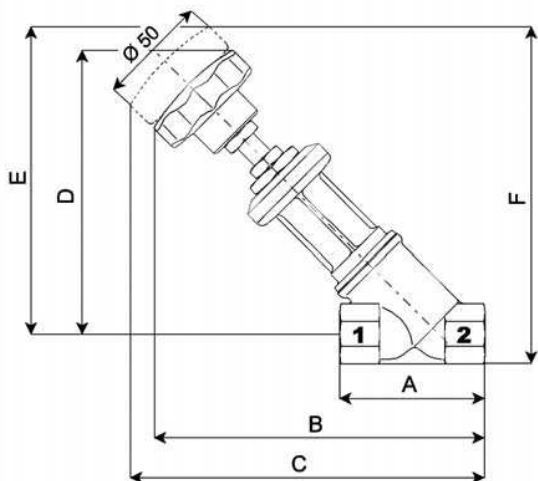

### DIMENSIONS & WEIGHTS

Connection	A	B	C	D	E	F	weight
(ISO 228 G)	(mm)	(mm)	(mm)	(mm)	(mm)	(mm)	(kg)
1/2"	65	142	150	121	128	142	0.75
3/4"	75	148	155	126	133	150	0.80
1"	90	163	172	135	145	165	1.20
1 1/4"	110	175	188	143	156	181	1.80
1 1/2"	120	180	193	148	161	189	2.10
2"	150	198	212	157	170	205	3.10