

Mod. 5940



● Pneumatic actuator single acting for butterfly sanitary valves (2944)

Ends clamp/ threaded din 11851/ welded. Actuator body: stainless steel 304. Pneumatic operated at 5 bar.

● Pneumatic actuator double acting for butterfly sanitary valves (2949)

Ends clamp / threaded DIN 11851 / welded. Actuator body: stainless steel 304. Pneumatic operated at 5 bar.

● Butterfly valve clamp ends

Stainless steel body AISI 316L. EPDM elastomer. Clamp ends in inches. Sanitary polish. Max. working pressure: 10 bar, Max temp: 120°C.

SPRING RETURN

CODE	SIZE	WEIGHT kg
5940 06 44	1"	4
5940 08 44	1 1/2"	4
5940 09 44	2"	4.5
5940 10 44	2 1/2"	4.9
5940 11 44	3"	5.25
5940 12 44	4"	6.25

DOUBLE ACTING

CODE	SIZE	WEIGHT kg
5940 06 49	1"	4
5940 08 49	1 1/2"	4
5940 09 49	2"	4.5
5940 10 49	2 1/2"	4.9
5940 11 49	3"	5.25
5940 12 49	4"	6.25

MED	A	B
1"	232	85
1 1/2"	236	85
2"	240	85
2 1/2"	249	85
3"	255	85
4"	269	85

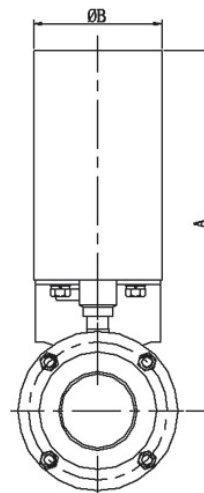

Mod. 5941E



● Pneumatic actuator single acting for butterfly sanitary valves (2944)

Ends clamp/ threaded din 11851/ welded. Actuator body: stainless steel 304. Pneumatic operated at 5 bar.

Pneumatic actuator double acting for butterfly sanitary valves (2949)

Ends clamp / threaded DIN 11851 / welded. Actuator body: stainless steel 304. Pneumatic operated at 5 bar.

Butterfly valve threaded ends

Stainless steel body AISI 304. EPDM elastomer.

Threaded ends DIN 11851. Max working pressure 10 bar, Max temp: 120°C.

SPRING RETURN

CODE	SIZE	WEIGHT kg
5941E 06 44	1"	4
5941E 07 44	1 1/4"	4.1
5941E 08 44	1 1/2"	4.4
5941E 09 44	2"	5.1
5941E 10 44	2 1/2"	5.85
5941E 11 44	3"	6.5
5941E 12 44	4"	8.1

DOUBLE ACTING

CODE	SIZE	WEIGHT kg
5941E 06 49	1"	4
5941E 07 49	1 1/4"	4.1
5941E 08 49	1 1/2"	4.4
5941E 09 49	2"	5.1
5941E 10 49	2 1/2"	5.85
5941E 11 49	3"	6.5
5941E 12 49	4"	8.1

MED	DN	A	B
1"	25	232	85
1 1/4"	32	236	85
1 1/2"	40	238	85
2"	50	246	85
2 1/2"	65	253	85
3"	80	260	85
4"	100	271	85

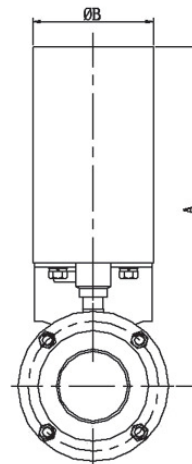

Mod. 5942E



● Pneumatic actuator single acting for butterfly sanitary valves (2944)

Ends clamp/ threaded din 11851/ welded. Actuator body: stainless steel 304. Pneumatic operated at 5 bar.

● Pneumatic actuator double acting for butterfly sanitary valves (2949)

Ends clamp / threaded DIN 11851 / welded. Actuator body: stainless steel 304. Pneumatic operated at 5 bar.

● Butterfly valve end threaded / welded

Stainless steel body AISI 304. EPDM elastomer. End threaded DIN 11851/welded. Max working pressure 10 bar, Max temp: 120°C.

SPRING RETURN

CODE	SIZE	WEIGHT kg
5942E 06 44	1"	3.93
5942E 07 44	1 1/4"	3.9
5942E 08 44	1 1/2"	4.13
5942E 09 44	2"	4.73
5942E 10 44	2 1/2"	5.35
5942E 11 44	3"	5.8
5942E 12 44	4"	6.9

DOUBLE ACTING

CODE	SIZE	WEIGHT kg
5942E 06 49	1"	3.93
5942E 07 49	1 1/4"	3.9
5942E 08 49	1 1/2"	4.13
5942E 09 49	2"	4.73
5942E 10 49	2 1/2"	5.35
5942E 11 49	3"	5.8
5942E 12 49	4"	6.9

MED	DN	A	B
1"	25	232	85
1 1/4"	32	236	85
1 1/2"	40	238	85
2"	50	246	85
2 1/2"	65	253	85
3"	80	260	85
4"	100	271	85

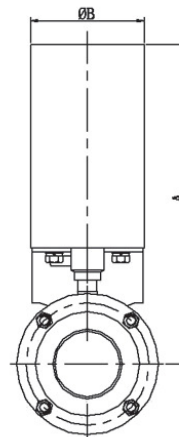

Mod. 5943E



● Pneumatic actuator single acting for butterfly sanitary valves (2944)

Ends clamp/ threaded din 11851/ welded. Actuator body: stainless steel 304. Pneumatic operated at 5 bar.

● Pneumatic actuator double acting for butterfly sanitary valves (2949)

Ends clamp / threaded DIN 11851 / welded. Actuator body: stainless steel 304. Pneumatic operated at 5 bar.

● Butterfly valve end welded / welded

Stainless steel body AISI 304. EPDM elastomer. End welded / welded. Max working pressure 10 bar. Max temp 120°C.

SPRING RETURN

CODE	SIZE	WEIGHT kg
5943E 06 44	1"	3.74
5943E 07 44	1 1/4"	3.93
5943E 08 44	1 1/2"	3.94
5943E 09 44	2"	4.35
5943E 10 44	2 1/2"	4.75
5943E 11 44	3"	5.05
5943E 12 44	4"	5.7

DOUBLE ACTING

CODE	SIZE	WEIGHT kg
5943E 06 49	1"	3.74
5943E 07 49	1 1/4"	3.93
5943E 08 49	1 1/2"	3.94
5943E 09 49	2"	4.35
5943E 10 49	2 1/2"	4.75
5943E 11 49	3"	5.05
5943E 12 49	4"	5.7

MED	DN	A	B
1"	25	232	85
1 1/4"	32	236	85
1 1/2"	40	238	85
2"	50	246	85
2 1/2"	65	253	85
3"	80	260	85
4"	100	271	85

